

DIRECT ACTING SOLENOID VALVE(3/2 WAY)

VS301 SERIES

Strokmatic
Automation Technology

Symbol

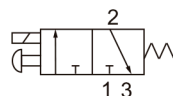

Product feature

1. Direct acting type and normally closed mode, flexible in direction change.
2. No need to add oil for lubrication.
3. Several valves can be installed integrately to save installation space.
4. Affiliated manual devices are equipped to facilitate installation and debugging.
5. Several standard voltage grades are optional.

Flow chart

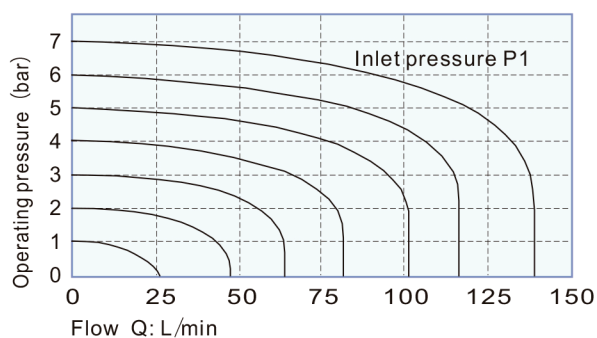

Ordering code

VS 3 0 1 - VC

① ② ③ ④ ⑤

①	Model VS: Solenoid valve
②	Valve Type 3: 3/2 Way
③	Series Code 0: 0 Serie
④	Port Size 1: 1/8" G
⑤	Voltage DC: DC12V VC: DC24V CA: AC110V DA: AC220V VA: AC24V

Specification

Valve	VS301
Fluid	Air(to be filtered by 40 μm filter element)
Acting	Direct acting
Port size	1/8"G
Valve type	3 port 2 position
Lubrication	Not required
Operating pressure	0~8bar(0~114psi)
Proof pressure	15bar(215psi)
Temperature °C	-20~70
Orifice size	Φ1.2mm
Material of body	Aluminum alloy

Coil specification

Item	Specification
Standard voltage	AC220V, AC110V, AC24V, DC24V, DC12V
Scope of voltage	AC:±15% DC:±10%
Power consumption	AC:3.5VA DC:3.0W
Protection	IP65(DIN40050)
Temperature classification	B Class
Electrical entry	Terminal
Activating time	0.05 sec and below
Max. frequency ①	10 cycle/sec

Note ①: The maximum actuation frequency is in the no-load state.

Inner structure

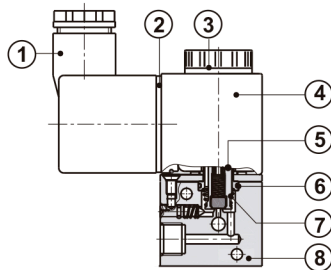

No.	Item
(1)	Connector
(2)	Gasket
(3)	Coil nut
(4)	Coil
(5)	Armature
(6)	O-ring
(7)	Return spring
(8)	Body

Dimensions

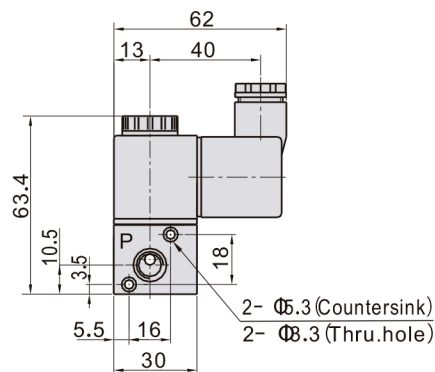
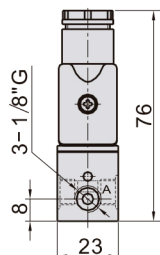
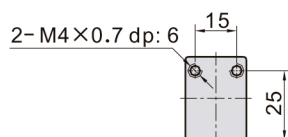

VS301 SERIES

Series connection

Dimensions (3F)

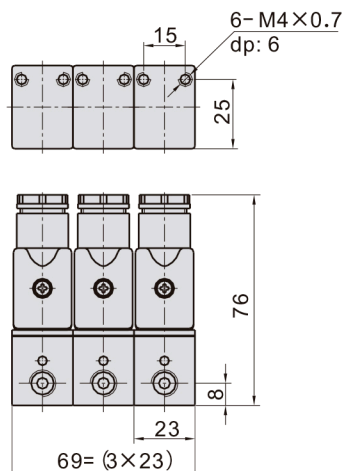

Dimensions (1F)

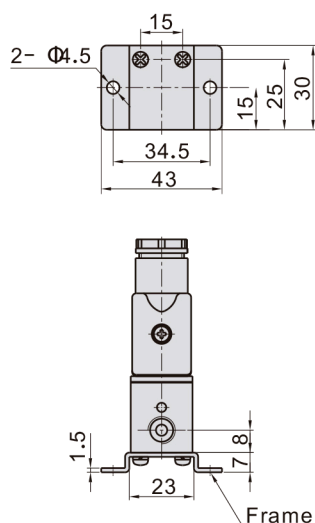

How to joint

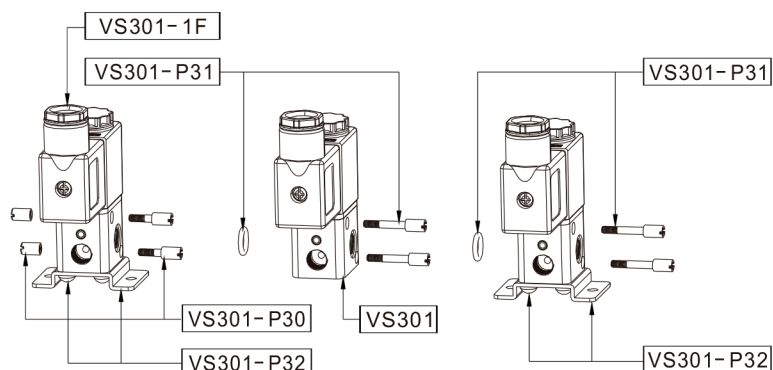

Product structure

Connection Amount\Q.TY	VS301	VS301-P30	VS301-P31	VS301-P32
VS301-□-1F	1	0	0	1
VS301-□-2F	2	1	1	1
.....	1
VS301-□-nF	n	1	n-1	2

Note: n is the number of junction valve, and $n \geq 3$

Ordering code for series

VS 3 0 1 - VC - 3F

① ② ③ ④ ⑤ ⑥

The above codes have included the series accessories, so it is unnecessary to order the accessories specially. But if you like, you could order as follows.

Code of accessories	Accessory name	Part code	Part name	Quantity
VS301-P30	Coupling screw assembly	F-VS301002B	Coupling screw(S)	2
		F-VS301003B	Coupling screw(M)	2
VS301-P31	Coupling screw assembly	GOR20008N75	O-Ring	1
		F-VS301004B	Coupling screw(L)	2
VS301-P32	Bracket assembly	F-VS301001B	Fixed mounting	1
		GSDA04008ZA	Cross round head screw	2

①	Model VS: Solenoid valve	⑤	Voltage DC: DC12V VC: DC24V CA: AC110V DA: AC220V VA: AC24V
②	Valve Type 3: 3/2 Way	⑥	Number of stations 1F: 1 Station 2F: 2 Station 3F: 3 Station 20F: 20 Station
③	Series Code 0: 0 Serie		
④	Port Size 1: 1/8" G		